



ASPIRE

— TO MOVE —



Weston Park East, Bath, BA1

Video and physical viewings available. Two bedroom ground floor flat located in Weston, Bath. The flat is offered furnished and is available now. The landlord is happy to consider students.

The property is located to the West of Bath city centre. There is a bus stop 0.1 miles away with buses to the city centre. Local amenities can be found in Weston, 0.4 miles away.

- Video viewing available
- Newly refurbished
- Two bedroom flat
- Furnished
- Communal parking and garden
- Available now to two students
- Holding deposit: £403

£1,750 Per month

Floor Plans

GROUND FLOOR
769 sq.ft. (71.4 sq.m.) approx.

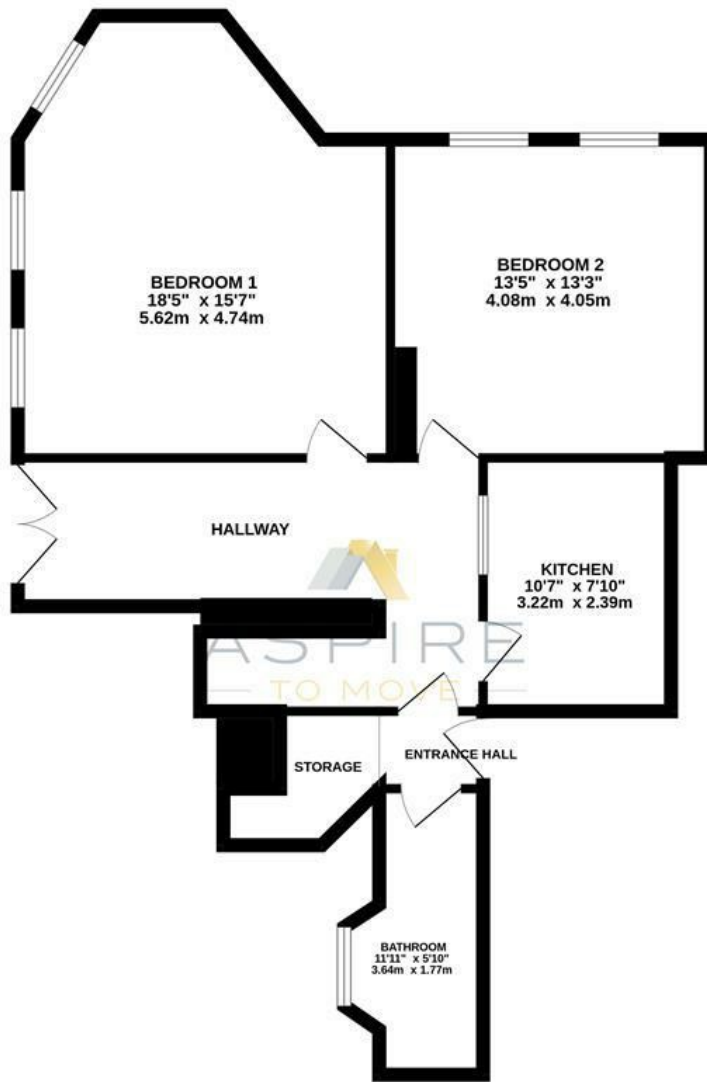

HILLSTEAD HOUSE, BATH, BA1

TOTAL FLOOR AREA : 769 sq.ft. (71.4 sq.m.) approx.

Whilst every attempt has been made to ensure the accuracy of the floorplan contained here, measurements of doors, windows, rooms and any other items are approximate and no responsibility is taken for any error, omission or mis-statement. This plan is for illustrative purposes only and should be used as such by any prospective purchaser. The services, systems and appliances shown have not been tested and no guarantee as to their operability or efficiency can be given.
Made with Metropix ©2026

Energy Performance Graph

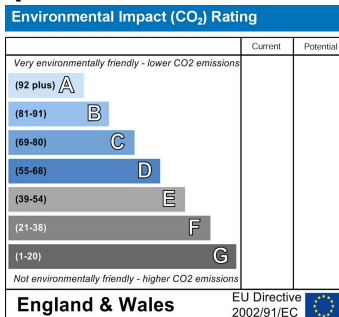
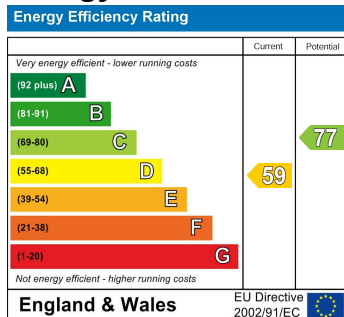

These particulars, whilst believed to be accurate are set out as a general outline only for guidance and do not constitute any part of an offer or contract. Intending purchasers should not rely on them as statements of representation of fact, but must satisfy themselves by inspection or otherwise as to their accuracy. No person in this firm's employment has the authority to make or give any representation or warranty in respect of the property.